

PG100 Capsule pressure gauge

Application scenarios

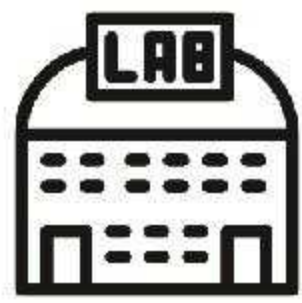

Lab

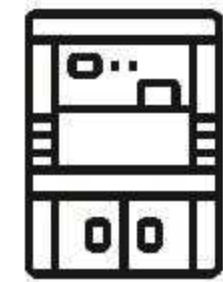

Medical equipment



Combustion device

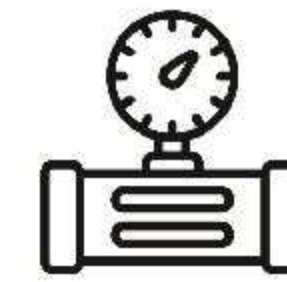

Gas pipeline measurement



Product features

Protection Level

The product structure is sturdy and durable, with a protection level of IP54

Range

0.3~60kPa

Accuracy

± 2.5%, ± 1.6%, ± 1.0% (optional)

Customize

Provide various options and fully customize with unique features

Product description

- PG100 is used to measure small pressures and is widely used in laboratories, medical equipment, combustion devices, gas pipelines, the environment, and many industrial fields.
- The connector material of the product is 304, and copper alloy and stainless steel 316L can also be selected to measure micro pressure in different scenarios.
- The dial diameters are 65mm, 75mm, 100mm, 160mm, and the thread can be selected as M20 × 1.5, G1/2, NPT1/2, M14 × 1.5 G1/4, NPT1/4. Mounting methods include axial and radial direct mounting, axial embedding, radial backplate mounting, etc. providing a variety of options, fully customize with unique features.

Technical parameter

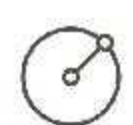

Dial diameter

65mm、75mm、100mm、160mm



Range

(0.3~60)kPa



Accuracy

±2.5%、±1.6%、±1.0% (Optional)



Operating temperature

(-15~+55) °C

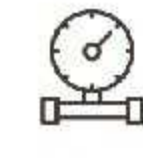

Shell

Stainless steel

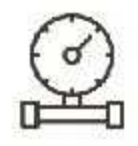

Capsule

Stainless steel, copper can be chosen



Core

Corrosion resistant stainless steel



Sealing

EPDM nitrile rubber



Protection level

IP54



Glass

Optional safety glass and organic glass



Process connection

Material: Stainless steel 304, copper alloy, stainless steel 316L can also be selected

Axial mounting and radial mounting are optional

Thread: M20 * 1.5, G1/2, NPT1/2 (100160 outer diameter gauge)

M14 * 1.5, G1/4, NPT1/4 (65,75 outer diameter gauge)

Specifications and dimensions

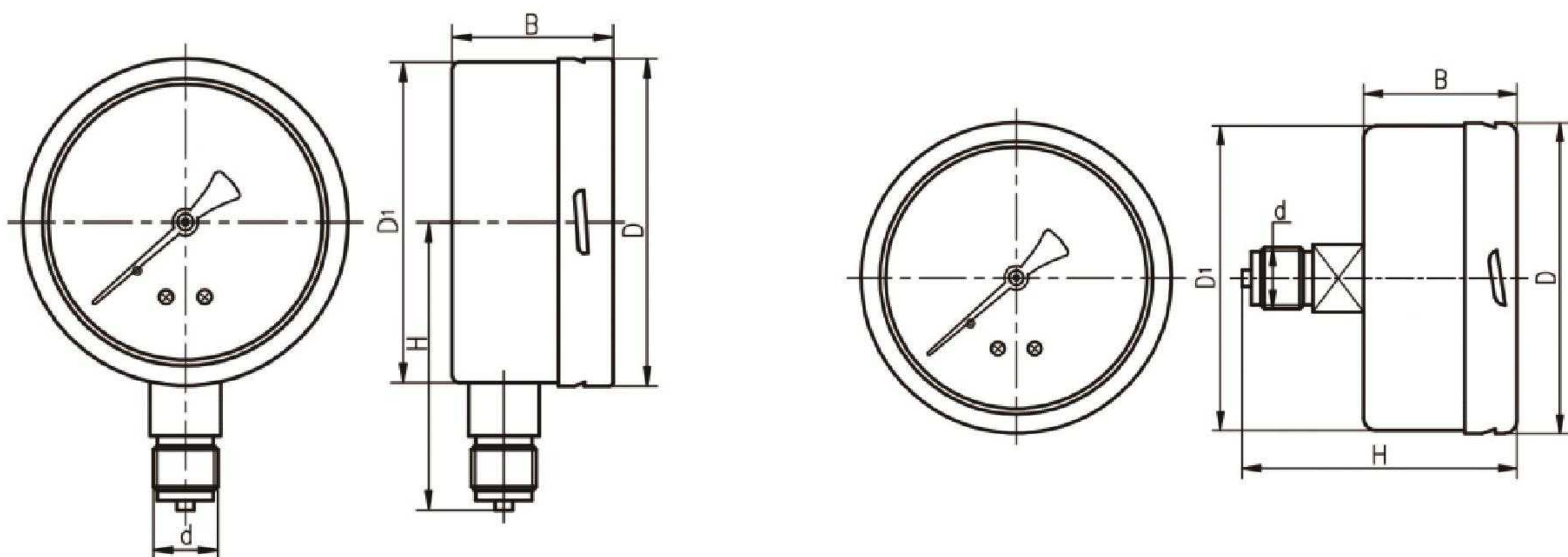

Radial edge mounting

Axial clamping edge mounting

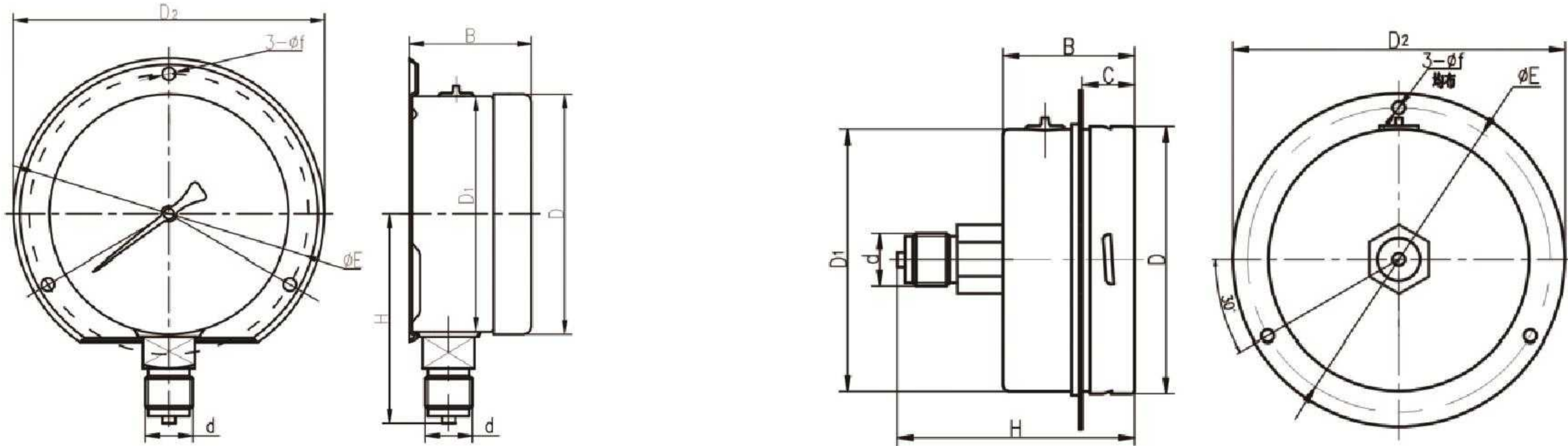

Model 型号尺寸	主体尺寸 Body size						卡边尺寸 Edge size		
	D	D1	B	C	H	Connector thread d 接头螺纹	D2	E	f
Radial Φ 100 径向	101	99	50		89/86	M20 X 1.5/NPT1/2	131.5	118	5.5
Axial Φ 100 轴向	101	99	50	18	92/89	M20 X 1.5/NPT1/2	128	118.5	5
Radial Φ 160 径向	160	159	50		202/199	M20 X 1.5/NPT1/2	196	178	6
Axial Φ 160 轴向	160	159	50	20	202/199	M20 X 1.5/NPT1/2	196	178	6

Dial diameter

- 65 φ65mm
- 75 φ75mm
- 100 φ100mm
- 160 φ160mm

Mounting method

- A Radial direct mounting
- C Axial direct mounting
- Y Customer provided requirement

Pressure Range

- XX Customer provided requirement

Thread Spec

- GM M20x1.5
- GN NPT1/2
- GT NPT1/4
- GO G1/4
- GP G1/2
- YY Customized

Special Options

- JT Connector material selection
- BP Special gauge panel
- YY Customized

PG100 Capsule pressure gauge

Selection rules:

Requirement: dial diameter 100mm, axial, (0-10) kPa, M20x1.5, 304 connector

Model selection: PG100-100CXXGMJT (0-10) kPa, 304 connector